

How to use the *Keybox Assistant*

XpressKEY®

1. Tap **Shackle**.
2. Type in the shackle code and tap **Enter**.
3. Tap **Put on a listing**.
4. Add the property address number and **Enter**.
5. Point the key at the keybox.
6. After the shackle releases, push down on the shackle, then pull up.
7. Tap **Done** to exit.

1. Tap **Shackle**.



How to use the *Keybox Assistant*

XpressKEY

1. Tap **Shackle**.
2. Type in the shackle code and tap **Enter**.
3. Tap **Put on a listing**.
4. Add the property address number and **Enter**.
5. Point the key at the keybox.
6. After the shackle releases, push down on the shackle, then pull up.
7. Tap **Done** to exit.

2. Type in the shackle code and tap **Enter**.



How to use the *Keybox Assistant*

XpressKEY

1. Tap **Shackle**.
2. Type in the shackle code and tap **Enter**.
3. Tap **Put on a listing**.
4. Add the property address number and **Enter**.
5. Point the key at the keybox.
6. After the shackle releases, push down on the shackle, then pull up.
7. Tap **Done** to exit.

3. Tap **Put on a listing**.



How to use the *Keybox Assistant*

XpressKEY

1. Tap **Shackle**.
2. Type in the shackle code and tap **Enter**.
3. Tap **Put on a listing**.
4. Add the property address number and **Enter**.
5. Point the key at the keybox.
6. After the shackle releases, push down on the shackle, then pull up.
7. Tap **Done** to exit.

4. Add the property address number and **Enter**.



How to use the *Keybox Assistant*

XpressKEY

1. Tap **Shackle**.
2. Type in the shackle code and tap **Enter**.
3. Tap **Put on a listing**.
4. Add the property address number and **Enter**.
5. Point the key at the keybox.
6. After the shackle releases, push down on the shackle, then pull up.
7. Tap **Done** to exit.

5. Point the key at the keybox.

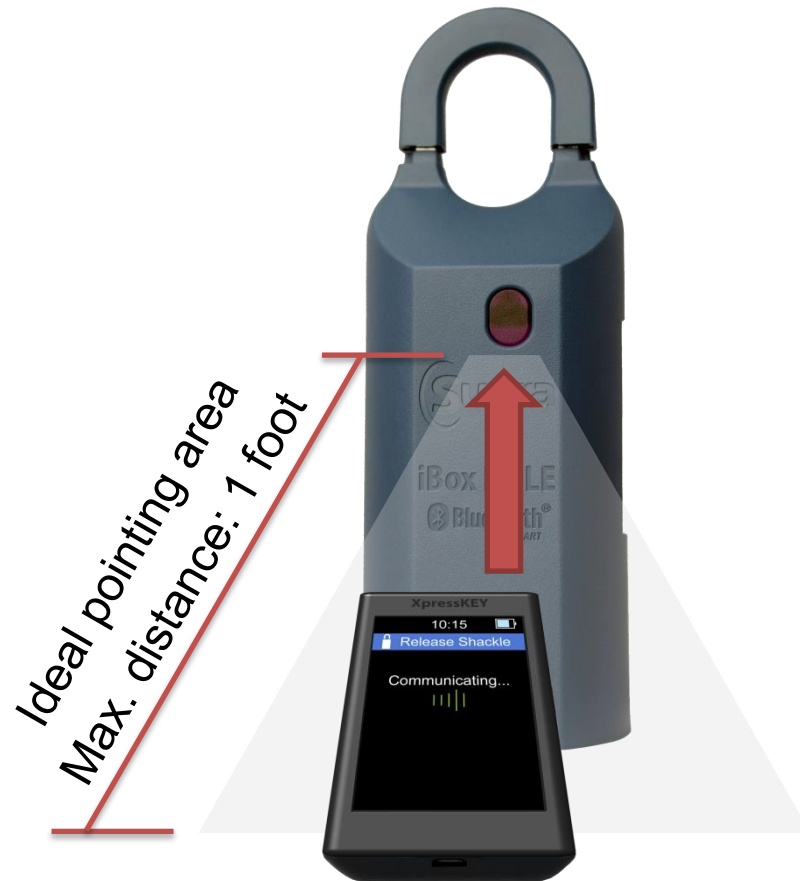

How to use the *Keybox Assistant*

XpressKEY

1. Tap **Shackle**.
2. Type in the shackle code and tap **Enter**.
3. Tap **Put on a listing**.
4. Add the property address number and **Enter**.
5. Point the key at the keybox.
6. After the shackle releases, push down on the shackle, then pull up.
7. Tap **Done** to exit.

6. Push down on the shackle and pull up.

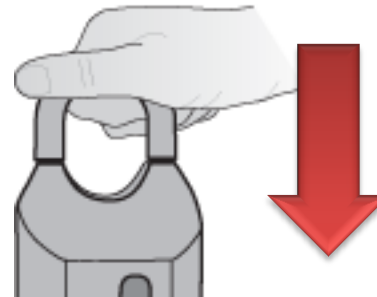

How to use the *Keybox Assistant*

7. Tap **Done** to exit.

XpressKEY

1. Tap **Shackle**.
2. Enter the shackle code and tap **Enter**.
3. Tap **Put on a listing**.
4. Add the property address number and **Enter**.
5. Point the key at the keybox.
6. After the shackle releases, push down on the shackle, then pull up.
7. Tap **Done** to exit.



For the latest information, visit us at www.supraekey.com and select the **Customer Support** tab.



© 2016 United Technologies Corporation. All rights reserved. Supra is a part of UTC Climate, Controls & Security (CCS), and a unit of United Technologies Corporation. Supra and XpressKEY are registered trademarks of United Technologies Corporation. Other brand and product names are or may be the trademarks of, and are used to identify products or services of, their respective owners.

